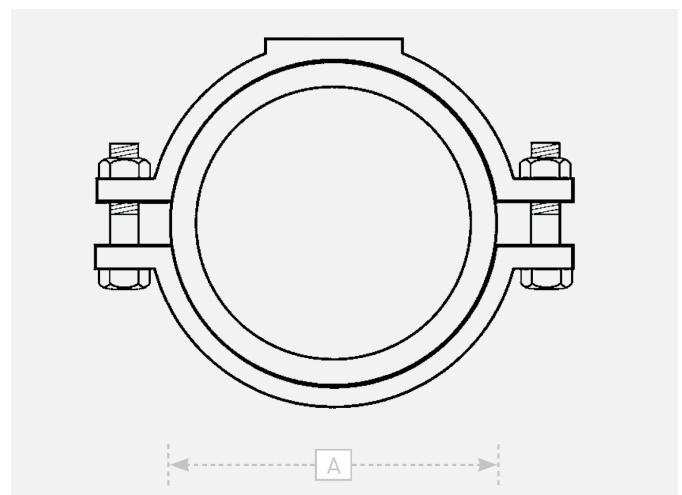

## TALBOT SELF TAPPING FERRULE STRAPS ASBESTOS CEMENT PIPE

**Gunmetal Banjo, Talbot Pushfit outlet for MDPE pipe no liner**

PRODUCT CODE	NOMINAL PIPE BORE	STRAP SIZE (A)	OUTLET
E11268	4" (100mm)	122 -130mm	20mm PF
E11364	4" (100mm)	122 -130mm	25mm PF

**TALBOT Self Tapping Ferrule Straps Asbestos Cement Pipe**

## TALBOT SELF TAPPING FERRULE STRAPS ASBESTOS CEMENT PIPE

### Plastic Banjo, Talbot Pushfit outlet for MDPE pipe with liner

PRODUCT CODE	NOMINAL PIPE BORE	STRAP SIZE (A)	OUTLET
E8358	3" (80mm)	96 - 101mm	20mm PF
E8359	3" (80mm)	96 - 101mm	25mm PF
E8360	3" (80mm)	96 - 101mm	32mm PF
E8361	4" (100mm)	122 - 130mm	20mm PF
E8362	4" (100mm)	122 - 130mm	25mm PF
E8363	4" (100mm)	122 - 130mm	32mm PF
E8364	6" (150mm)	177 - 185mm	20mm PF
E8365	6" (150mm)	177 - 185mm	25mm PF
E8366	6" (150mm)	177 - 185mm	32mm PF

### Plastic Banjo, Talbot Pushfit outlet for MDPE pipe no liner

PRODUCT CODE	NOMINAL PIPE BORE	STRAP SIZE (A)	OUTLET
E8744	3" (80mm)	96 - 101mm	¾" PF
E8742	4" (100mm)	122 - 130mm	¾" PF
E8743	6" (150mm)	177 - 185mm	¾" PF

Working Pressure : Up to 16 bar (240 psi)

Temperature : Up to 40°C

Sizes	Mains Pipe:	From 80mm (3")	
	Stems:	½" - 1"	
	Outlets:	Talbot Pushfit for PE	20mm (½") to 32mm (1")

Materials:	Metals:	Gunmetal to BS EN 1982:2008 CC491K
		Stainless Steel Cutter
	Plastics:	Acetal or Polypropylene
	Fasteners:	Stainless Steel (A2 and A4)
	Seals:	Nitrile or EPDM rubber

The pressure stated above applies with water temperatures up to 20°C.

For further information relating to operating temperatures please contact our Customer Service department on 0845 077 9797.

The technical data and performance may be modified without prior notice depending on the technical advances.

### TALBOT Self Tapping Ferrule Straps Asbestos Cement Pipe